



# RK/F-320LSA

OUTPUT: APPROX 1.0~55W

Carbon Brush Motors

代表的用途: 家用电器、泵  
自行车电装机器

Typical Applications/Household Appliances  
Automotive Products



MODEL	VOLTAGE		NO LOAD		AT MAXIMUM EFFICIENCY				STALL	
	OPERATING RANGE	NOMINAL	SPEED	CURRENT	SPEED	CURRENT	TORQUE	OUTPUT	TORQUE	CURRENT
			r/min	A	r/min	A	g. cm	W	g. cm	A
RK-320LSA-20178A	4-8V	6.0V	6861	0.058	5882	0.348	25	1.45	179	2.092
RK-320LSA-08755	22-26V	24.0V	6343	0.018	1855	0.085	24	1.26	138	0.398

UNIT: MILLIMETERS

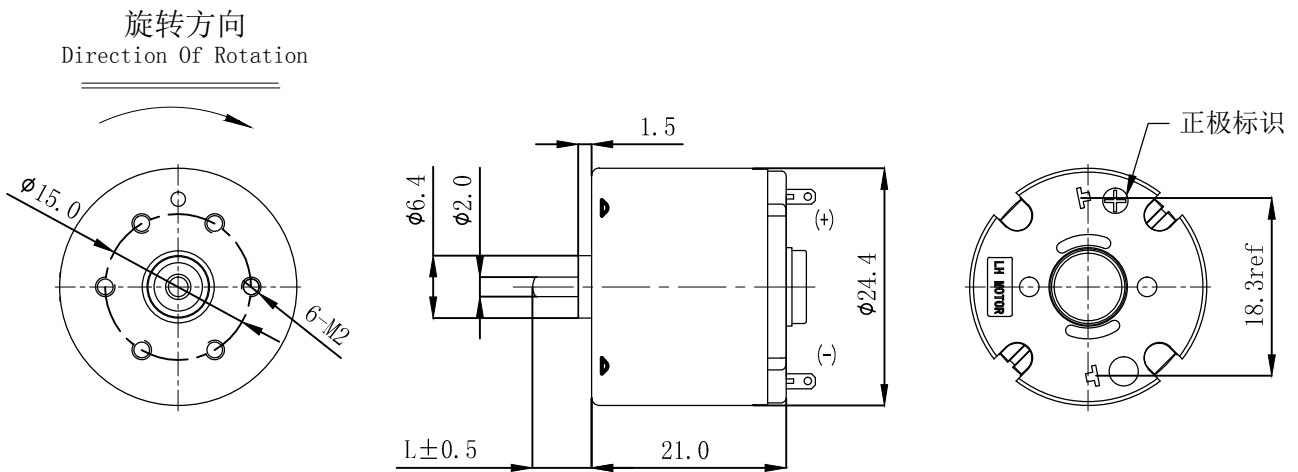

WEIGHT: 20g (APPROX)

RK-320LSA-20178A

6.0V

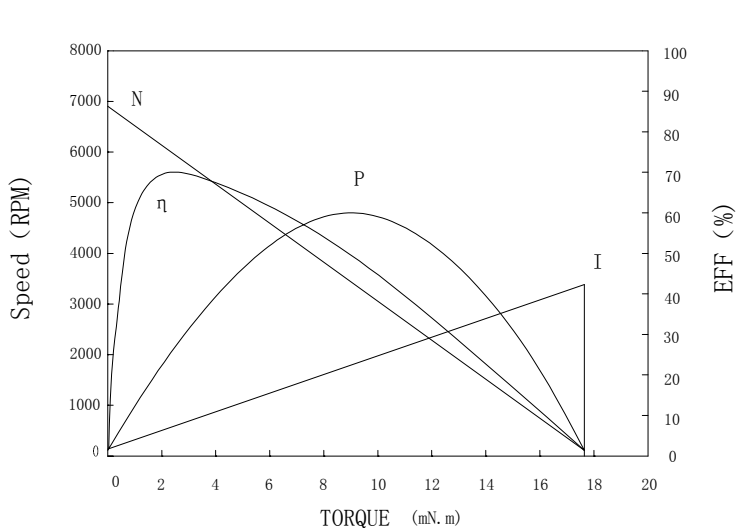

At No Load

Speed: 6861 RPM  
Current: 0.058 AMPS

At stall (Extrapolated)

Torque: 17.59 mN.m  
Current: 2.092 AMPS

At maximum efficiency

Efficiency: 69.5 %  
Torque: 2.510 mN.m  
Speed: 5882 RPM  
Current: 0.348 AMPS  
Output: 1.45 Watts

At maximum Power output

Output: 2.966 Watts  
Torque: 8.793 mN.m  
Speed: 3626 RPM  
Current: 1.02 AMPS

Characteristics

Torque constant  $K_t$ : 8.647 mN.m/APM  
E. M. F. constant  $E_c$ : 8.647 mV/rad/sec  
Dynamic resistance: 2.8684 Ohms  
Motor regulation  $M_r$ : 390.13 RPM/mN.m