

RF/RK-500TB/SB

OUTPUT: APPROX 0.1~4.5W

Precious metal/Carbon-brush motors

代表的用途: VCD、电动阀门、飘香机
警示灯、感应洁具、

VCD Electric valve Fragrance machine
Warning light Induction sanitary ware



MODEL	VOLTAGE		NO LOAD		AT MAXIMUM EFFICIENCY				STALL	
	OPERATING RANGE	NOMINAL	SPEED	CURRENT	SPEED	CURRENT	TORQUE	OUTPUT	TORQUE	CURRENT
			r/min	A	r/min	A	mN.m	W	g.cm	A
RF-500TB-18280	1-5V	3.0V	2700	0.03	2307	0.129	1.07	0.25	65	0.65
RF-500TB-12560	2-7V	6.0V	2700	0.014	2275	0.064	1.08	0.27	63	0.31
RF-500TB-14415	2-7V	6.0V	3700	0.028	2986	0.141	1.76	0.55	79	0.59

UNIT: MILLIMETERS

旋转方向
Direction Of Rotation

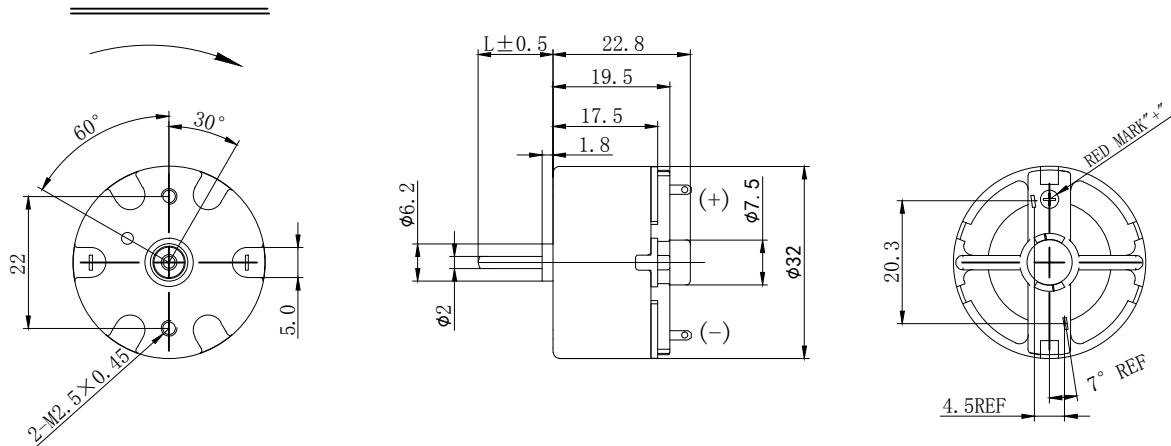

WEIGHT: 39g (APPROX)

RF-500TB-18280

3.0V

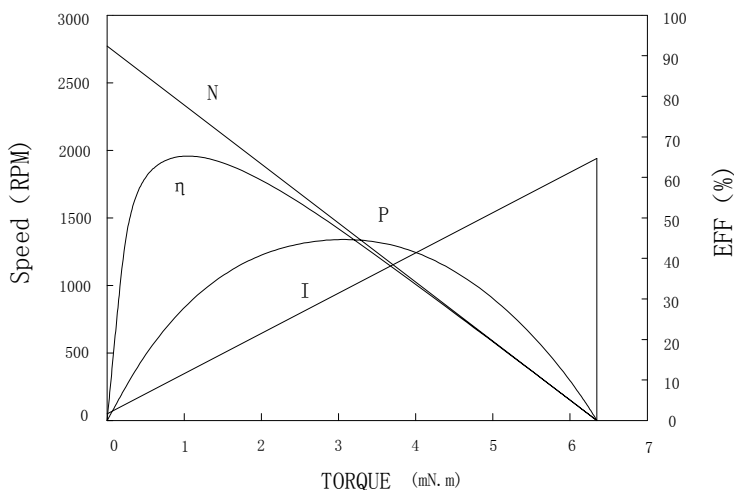

At No Load

Speed: 2773 RPM
Current: 0.026 AMPS

At stall (Extrapolated)

Torque: 6.36 mN.m
Current: 0.636 AMPS

At maximum efficiency

Efficiency: 63.7 %
Torque: 1.070 mN.m
Speed: 2307 RPM
Current: 0.129 AMPS
Output: 0.25 Watts

At maximum Power output

Output: 0.439 Watts
Torque: 3.182 mN.m
Speed: 1505 RPM
Current: 0.31 AMPS

Characteristics

Torque constant K_t : 10.426 mN.m/APM
E. M. F. constant E_c : 10.426 mV/rad/sec
Dynamic resistance: 4.7136 Ohms
Motor regulation M_r : 435.71 RPM/mN.m